



Round 1 Public Meeting

June 2021

TRANSIT-ORIENTED DEVELOPMENT PLANNING STUDY

Meeting Agenda

- Welcome & Introductions – 10 min.
- Project Background & Overview – 40 min.
- Next Steps & Ways to Stay Involved – 10 min.
- Question & Answer Session – 30 min.

Zoom Instructions

The image shows a Zoom meeting interface with several instructional callouts:

- Mute and unmute your audio to speak. Please mute yourself upon entering the meeting.** (Pink box pointing to the Unmute button in the bottom toolbar)
- Start and stop your video** (Green box pointing to the Start Video button in the bottom toolbar)
- Provide your name and company name under participants. Hover over "More" by your name and click "Rename."** (Blue box pointing to the Participants button in the bottom toolbar and the More menu in the top right)
- Ask questions, make comments and introduce yourself in the chat.** (Red box pointing to the Chat button in the bottom toolbar and the chat window on the right)

The Zoom interface includes a grid of participant video thumbnails, a bottom toolbar with buttons for Unmute, Start Video, Security, Participants, Chat, Share Screen, Record, Reactions, and Leave, and a right-hand sidebar with a Participants list, Invite, Mute All, More, Chat, and a message input field.

Project Team

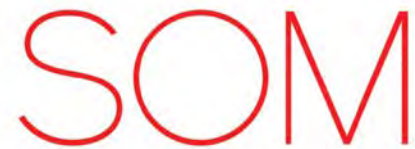
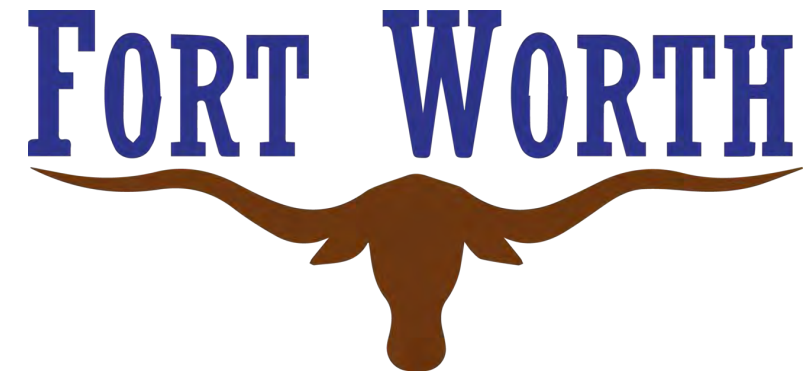

Project Background

- The City of Fort Worth initiated a study in 2019 called **“Transit Moves Fort Worth”** to **increase transit's role** in the overall **transportation system**.
- The study identified **priority corridors** and recommended **high-capacity transit**.
- **East Lancaster Avenue** was one of the priority corridors for development and is the **highest ridership corridor** in the **Trinity Metro bus network**.



East Lancaster Corridor: Places

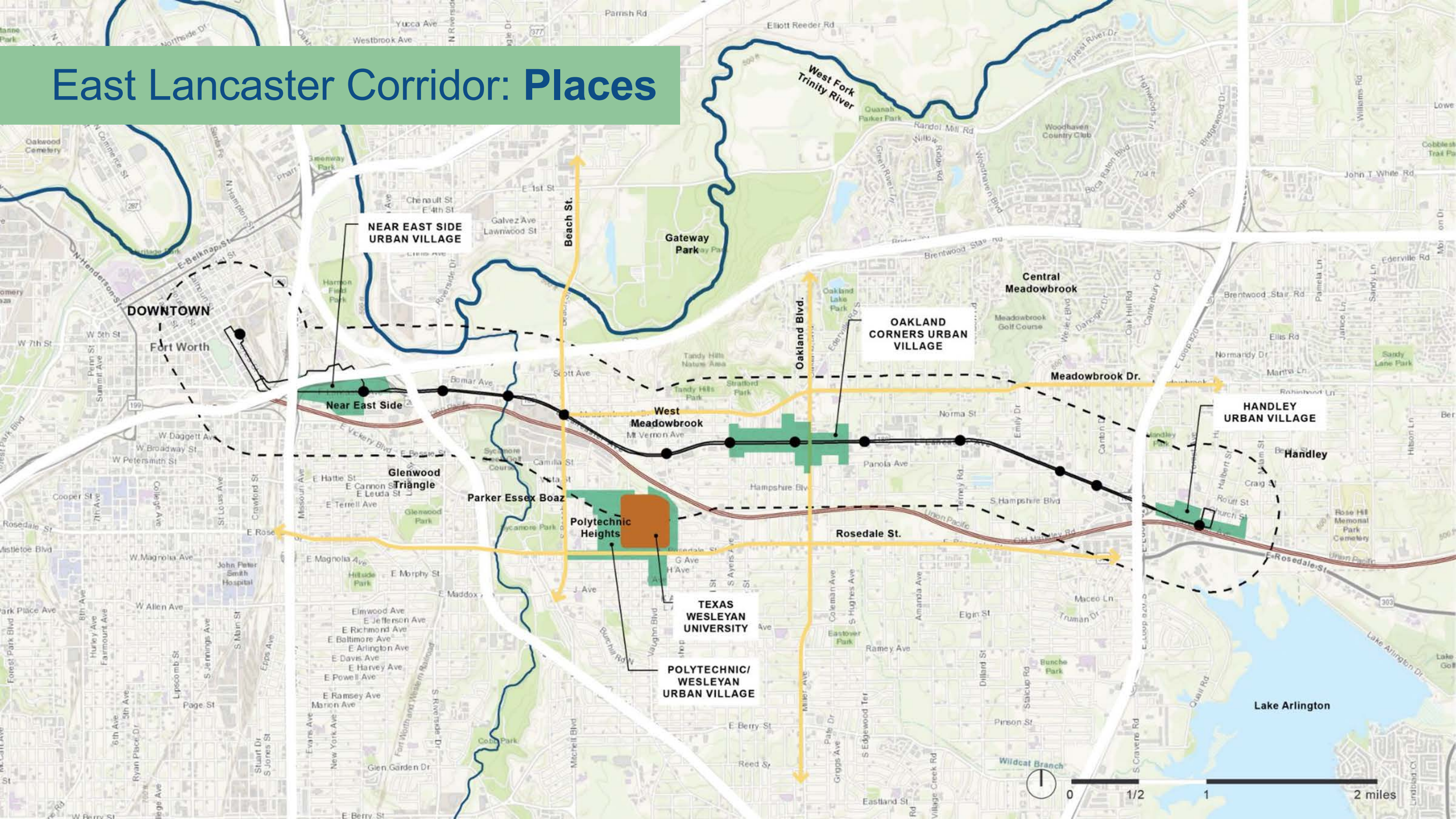

East Lancaster Corridor: Places



East Lancaster Corridor: Connectivity

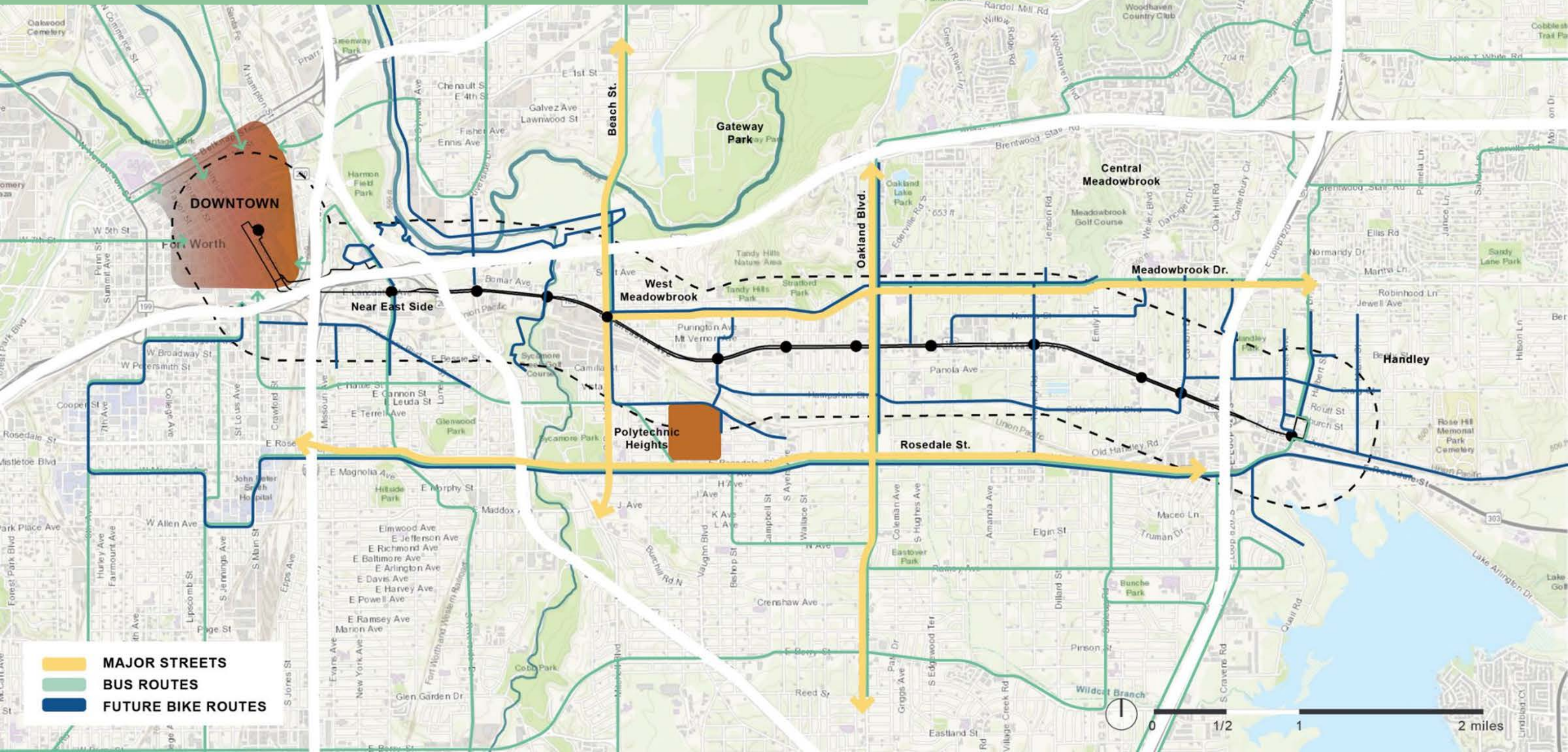

East Lancaster Corridor: Nearby Neighborhoods

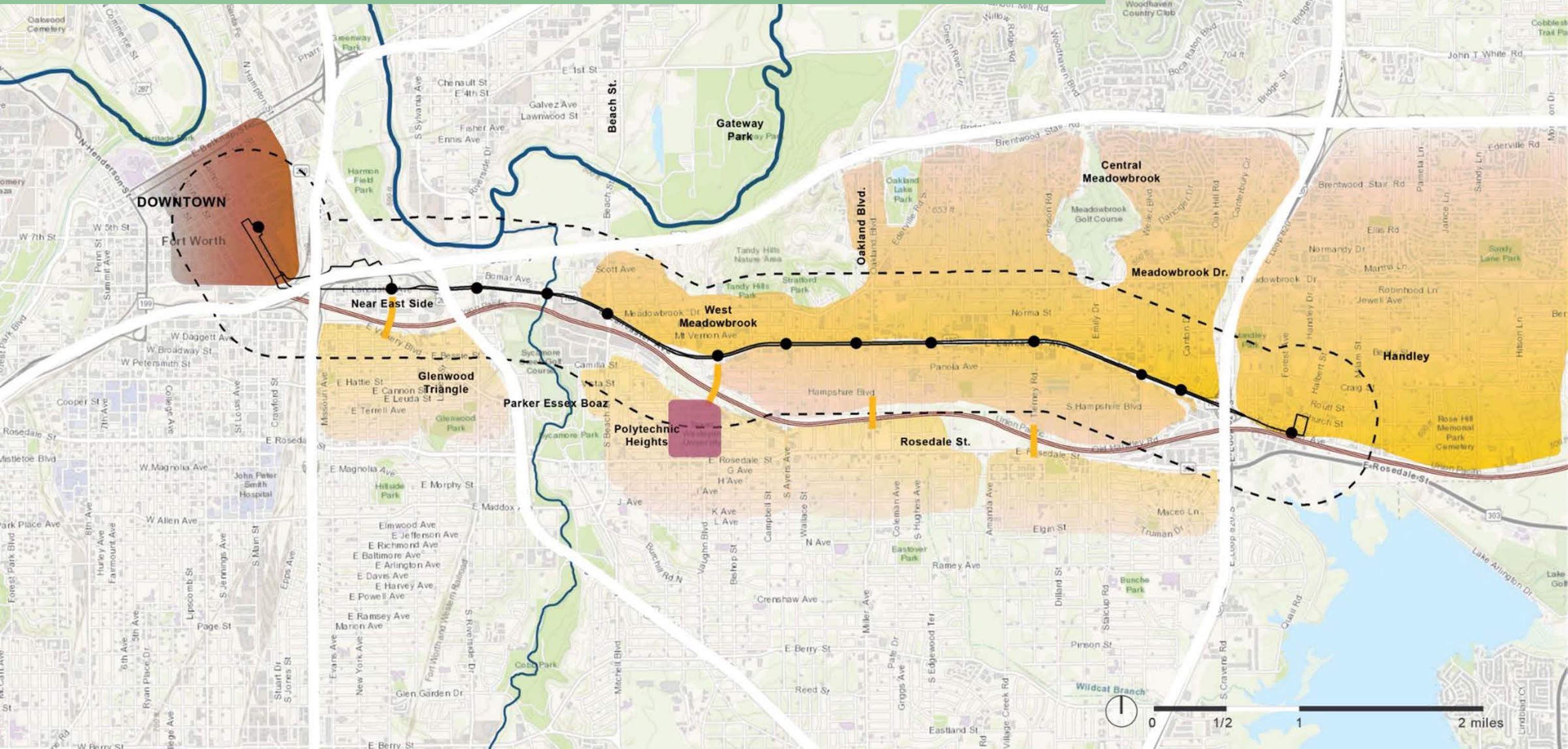

Project Goals & Objectives

Advancing East Lancaster's goal is to develop a plan to increase accessibility and create opportunities for economic development.

The objectives of this plan include:

- Guiding **growth** and **economic development** in the corridor
- Enabling **residents**, commuters, **businesses**, and students to benefit from **improved accessibility to downtown** and the East Lancaster corridor
- Create opportunities to **repurpose** and **redevelop** underutilized **land** currently serving single-occupancy vehicles on a 6-lane road



Timeline

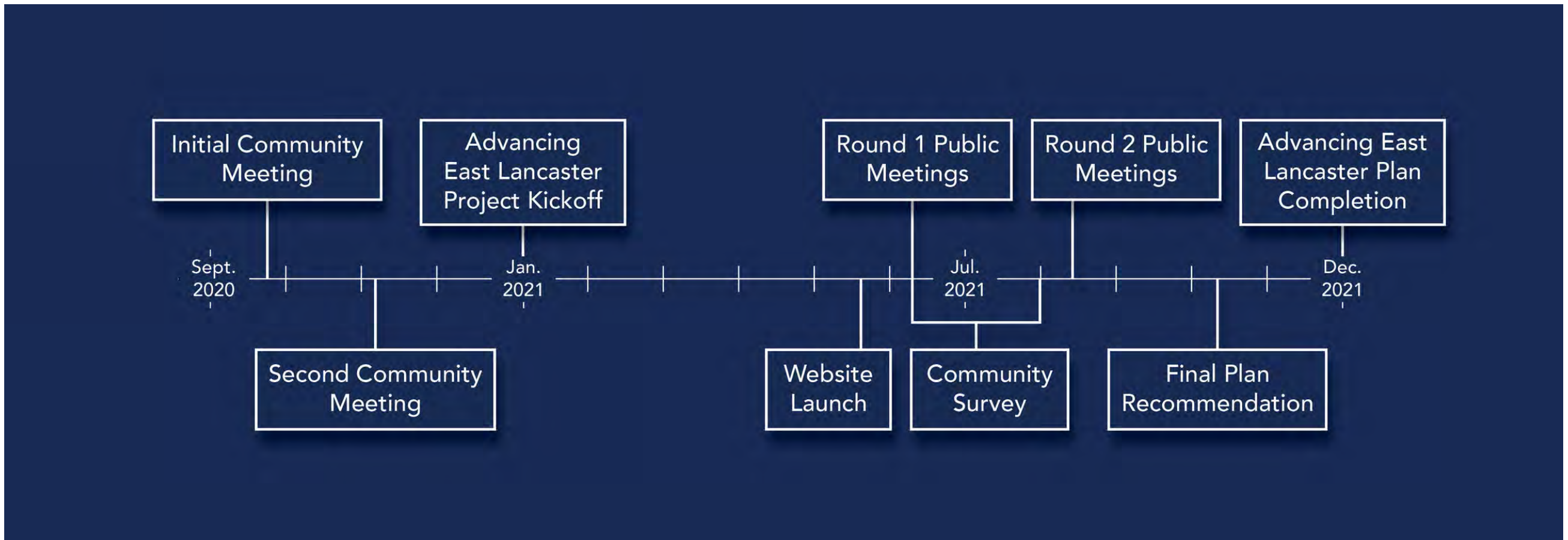



What is Transit-Oriented Development? Best Practices

TRANSIT-ORIENTED DEVELOPMENT PLANNING STUDY

Transit-Oriented Development Plan Objectives

- Benefit existing residents and businesses along the corridor with **new housing, retail and service options**
- Enable residents, commuters, businesses and students to benefit from **improved accessibility** to downtown and the East Lancaster corridor
- Guide **growth and economic development** in the corridor
- Accommodate a **growing population**
- Maximize the potential for **mixed-use development** at priority places in the East Lancaster corridor
- Create opportunities to **repurpose and redevelop underutilized land**





Core TOD Concepts

TRANSIT-ORIENTED DEVELOPMENT PLANNING STUDY



Illustration by Christopher Illustrations

What is Transit-Oriented Development (TOD)?

- Places where **development and transit** support each other
- Growing **cities, downtowns, neighborhoods, suburbs**
- Compact, **walkable**, mixed-use communities
- **Focused hubs** for stores, community services, jobs
- **New housing**
- **Heights, activity, density linked to transportation and transit**
- High-quality **streets, sidewalks and bike routes**
- **Reduced parking demand**





TOD at its Best

TRANSIT-ORIENTED DEVELOPMENT PLANNING STUDY



Illustration by Guang Ai

Vibrant Hubs



Neighborhood Amenities



Cafes



Historic re-use



Food and beverage



Pop-ups and gathering spots



Places to live

Diverse Housing Opportunities

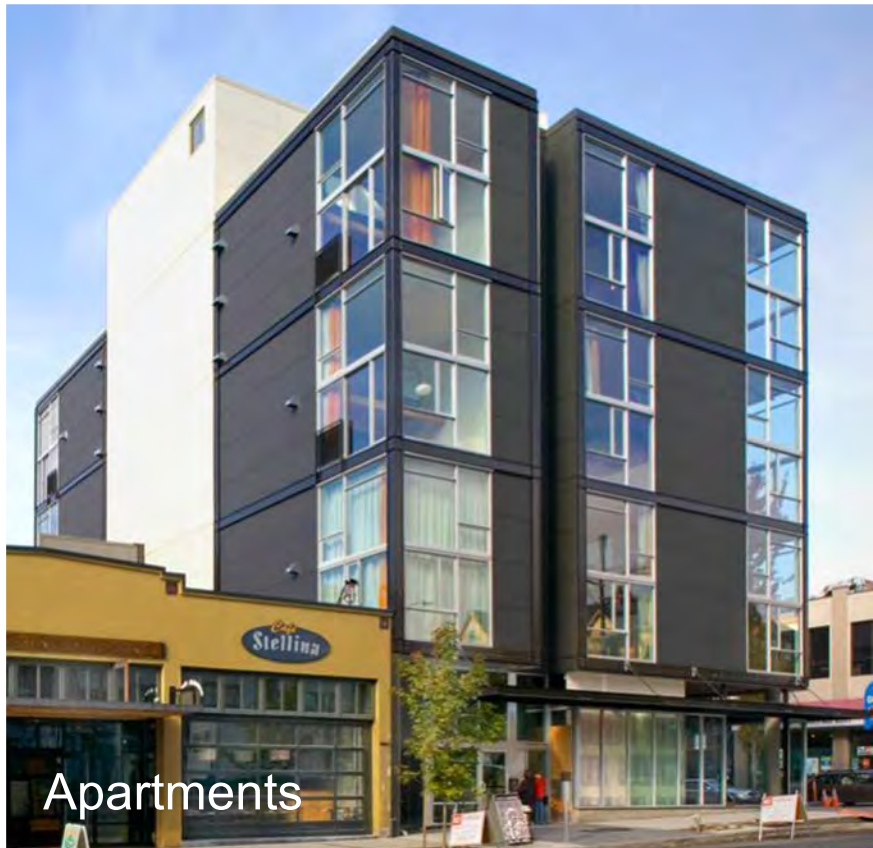
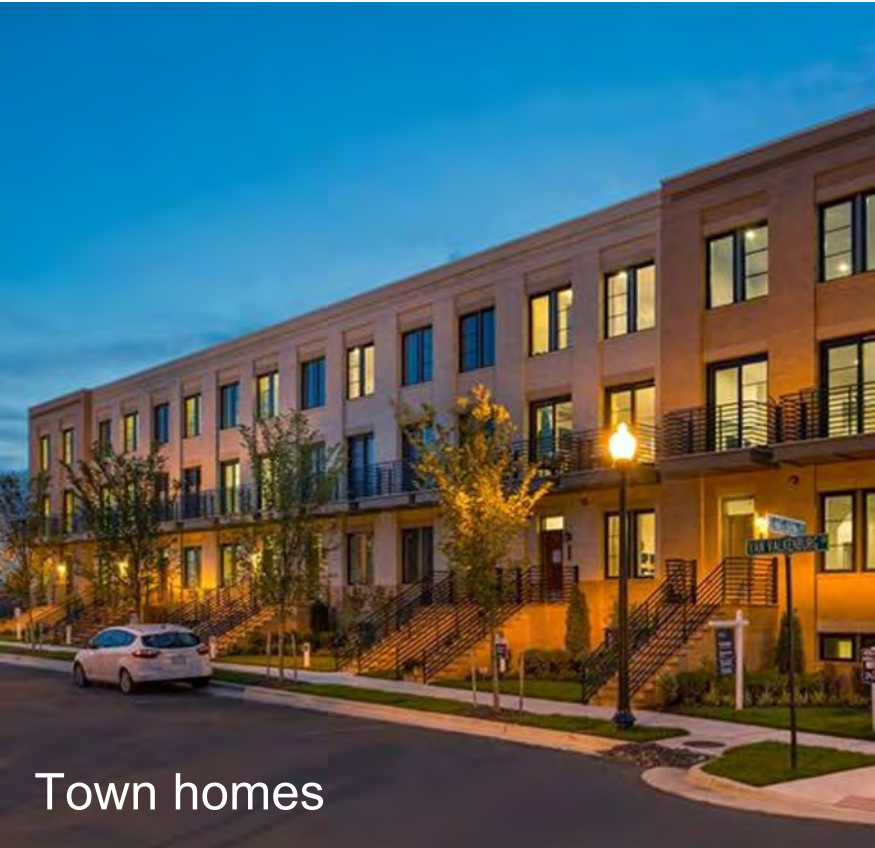
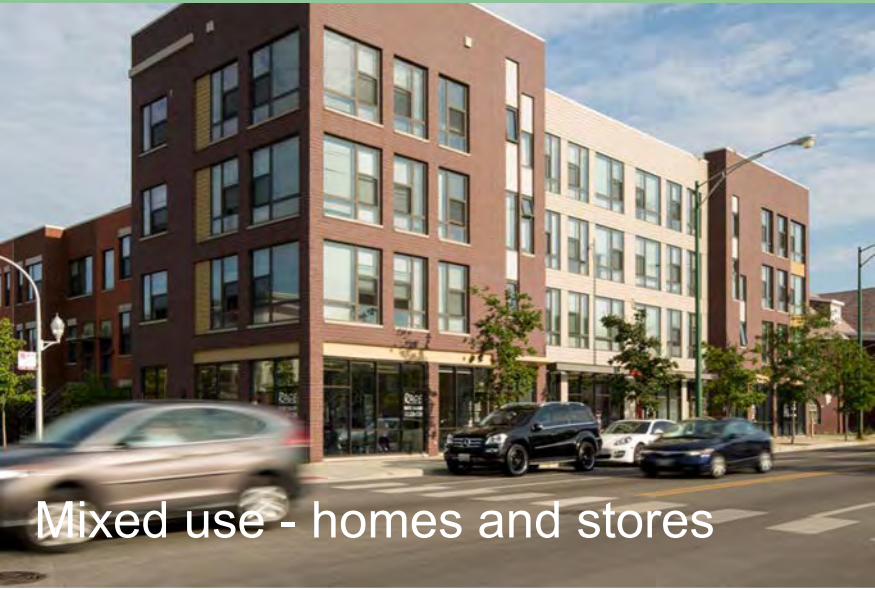

Supporting Existing Residents, Preserving Affordability



Existing homes



Neighborhood housing



Neighborhood housing



Supportive housing



Choice neighborhoods



Accessory units

Efficient Mobility



Multi-modal - all vehicles



Walkable streets



Bikes and bus

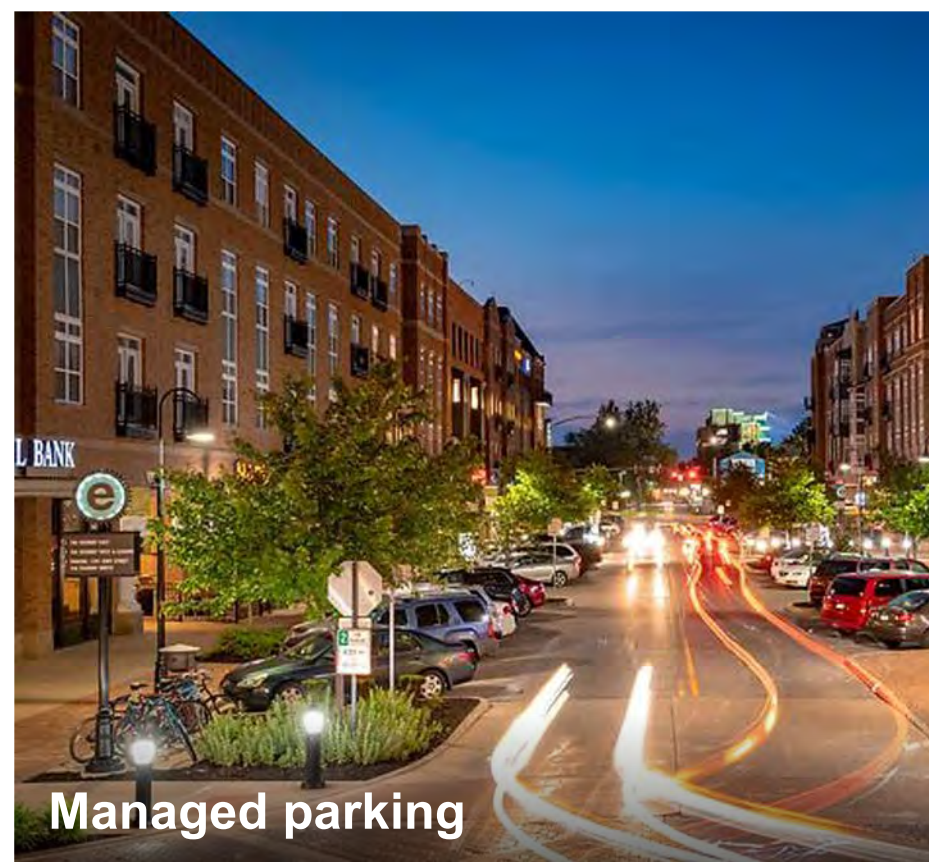

Managed parking



Safe crossings

Streets for People



Activated ground floors



Active sidewalks

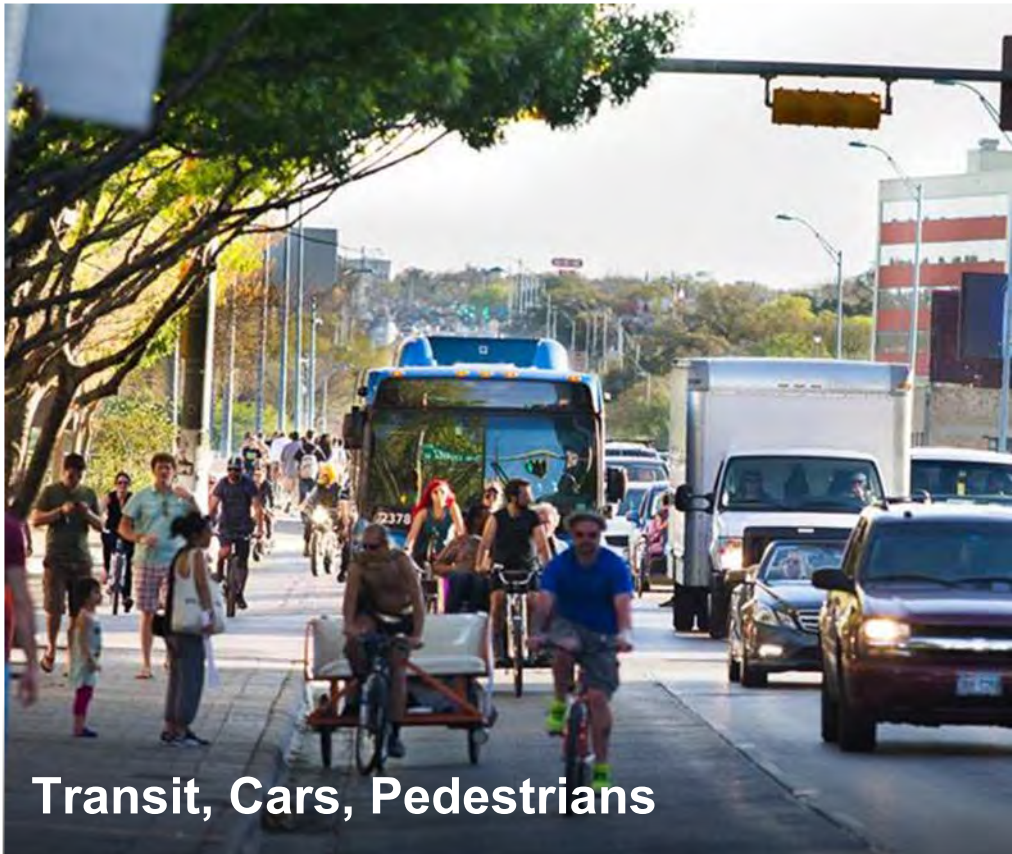

Transit, Cars, Pedestrians



Many Uses



All Types of Transit Modes



Pedestrian Comfort

Active Public Spaces



Play structures



Shared history



Active spaces



Neighborhood play



Health and wellbeing



Community food

Poll Question





What TOD can mean for East Lancaster

TRANSIT-ORIENTED DEVELOPMENT PLANNING STUDY



TOD Aspirations

TRANSIT-ORIENTED DEVELOPMENT PLANNING STUDY

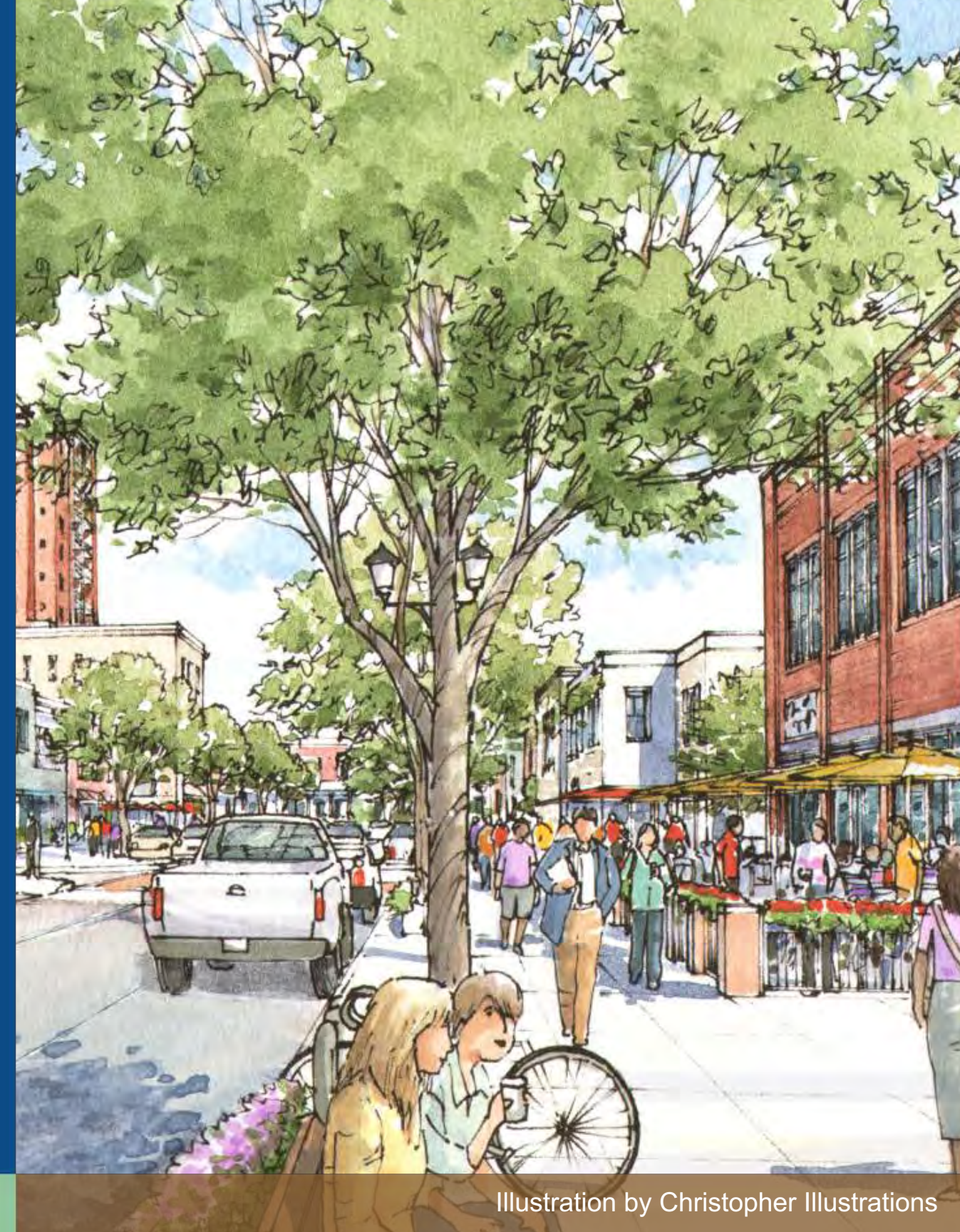

Illustration by Christopher Illustrations

Active Community Hubs

Southlake Town Square, Southlake, TX



New Homes

Adaptive Reuse Community Business



Locust Cider, Fort Worth, TX



Small Business Opportunities

Grow DeSoto Marketplace, DeSoto, TX

A photograph of four young people standing in a grassy area in front of a vibrant, colorful mural. The mural features the words 'RAMEY'S MARKET' and 'STOP' in large, stylized letters. The 'STOP' sign is filled with illustrations of various fruits like pineapples, strawberries, and grapes. The people are eating fruit, likely apples or oranges. The woman on the far left is wearing a black t-shirt with a graphic. The woman next to her is wearing a blue t-shirt. The woman in the center is wearing a blue t-shirt with a white graphic that says 'WILDCAT, ALWAYS A WILDCAT'. The man on the far right is wearing a white t-shirt with a blue and orange 'Savage' logo. The overall scene is bright and cheerful, representing a community event focused on healthy eating.

Food & Culture

Blue Zones Project
Ramey Market, Fort Worth, TX

Health

Blue Zones Project
Fort Worth, TX





Community

Blue Zones Project
Rufino Mendoza Elementary, Fort Worth, TX

A group of five children are participating in a parade, holding up colorful pinwheels. The children are diverse in age and ethnicity. The pinwheels have five petals in various colors: purple, yellow, green, blue, and pink. The background is a blurred outdoor setting, likely a street during a parade. The text 'an Energized Place' is overlaid in white, bold font across the center of the image.

an Energized Place

Tarrant County Juneteenth Parade, Fort Worth, TX



Public Spaces for people

India Basin Master Plan, San Francisco, CA

Great Streets



Magnolia Avenue, Fort Worth, TX



Affordable Housing

Ellis Townhomes, Cedar Rapids, TX

Poll Question



East Lancaster Corridor: Places



BREAK FOR QUESTIONS

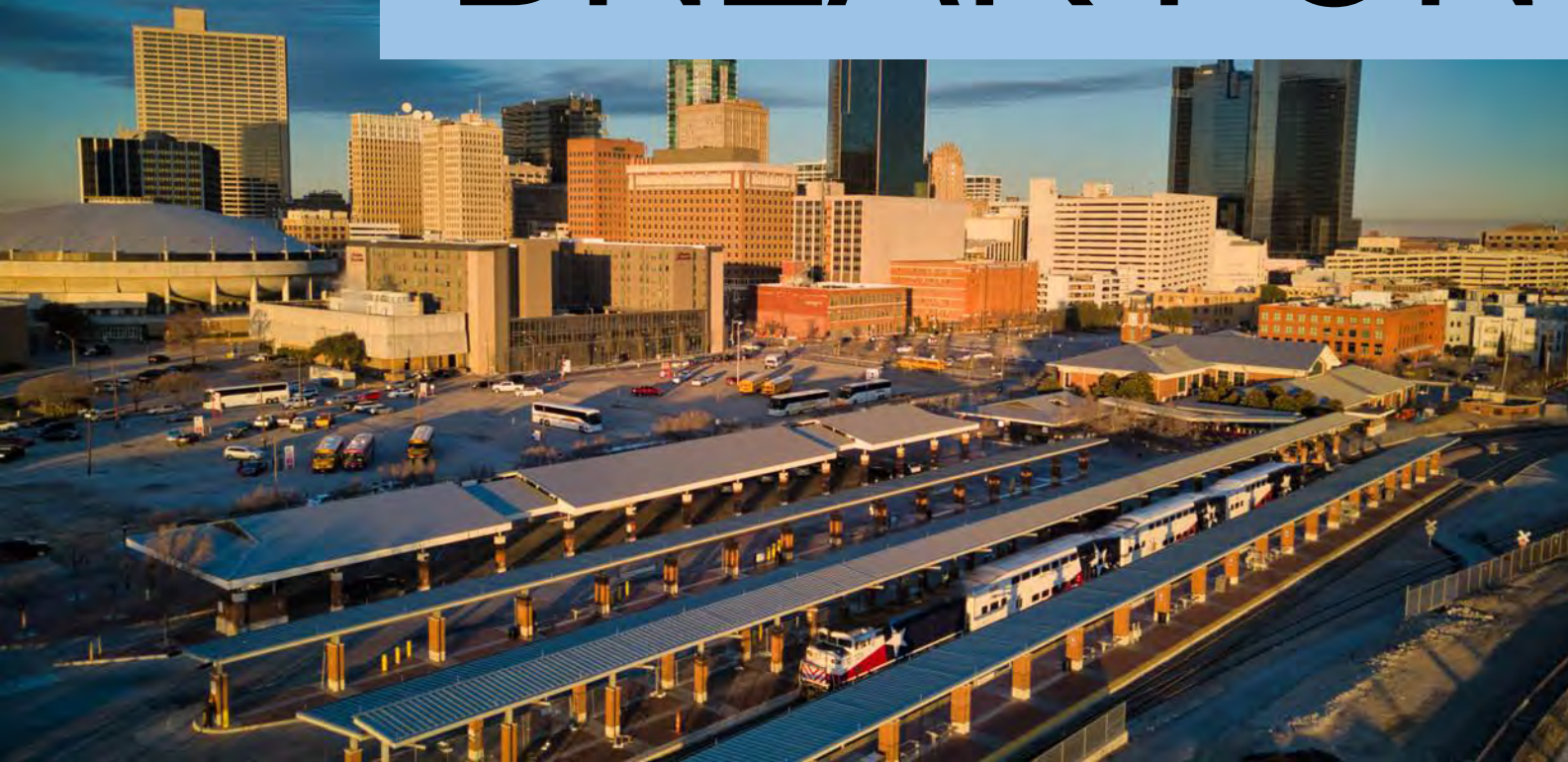



TOD Station Areas - Types

TRANSIT-ORIENTED DEVELOPMENT PLANNING STUDY



Illustration by Christopher Illustrations

What is a Station Area Type?

Responds to:

- Primary role of the station area within the corridor - work, shop, service, live
- How big the area is that shoppers, visitors or workers come from / number that visit
- Level of traffic, size of streets and highways
- Level of transit service and transit interchanges
- Type of development in the surrounding area today
- Intensity of activity today and in the future
- Height and density of future development



What Station Area Types could apply to East Lancaster?

1. **Downtown Core:** a major mixed-use center, with high density urban living
2. **Urban Village:** unique mixed-use destinations, with visitors from across Fort Worth
3. **Corridor Hub:** a corridor focus serving residents, transit riders and passing traffic
4. **Local Hub:** meeting the needs of local neighborhood residents
5. **Neighborhood Living:** new housing to meet local needs
6. **Regional Amenity:** open spaces, recreation, water management



Station Area Types and Potential Locations

- DOWNTOWN CORE
- URBAN VILLAGE
- CORRIDOR HUB
- LOCAL HUB
- NEIGHBORHOOD LIVING
- REGIONAL AMENITY

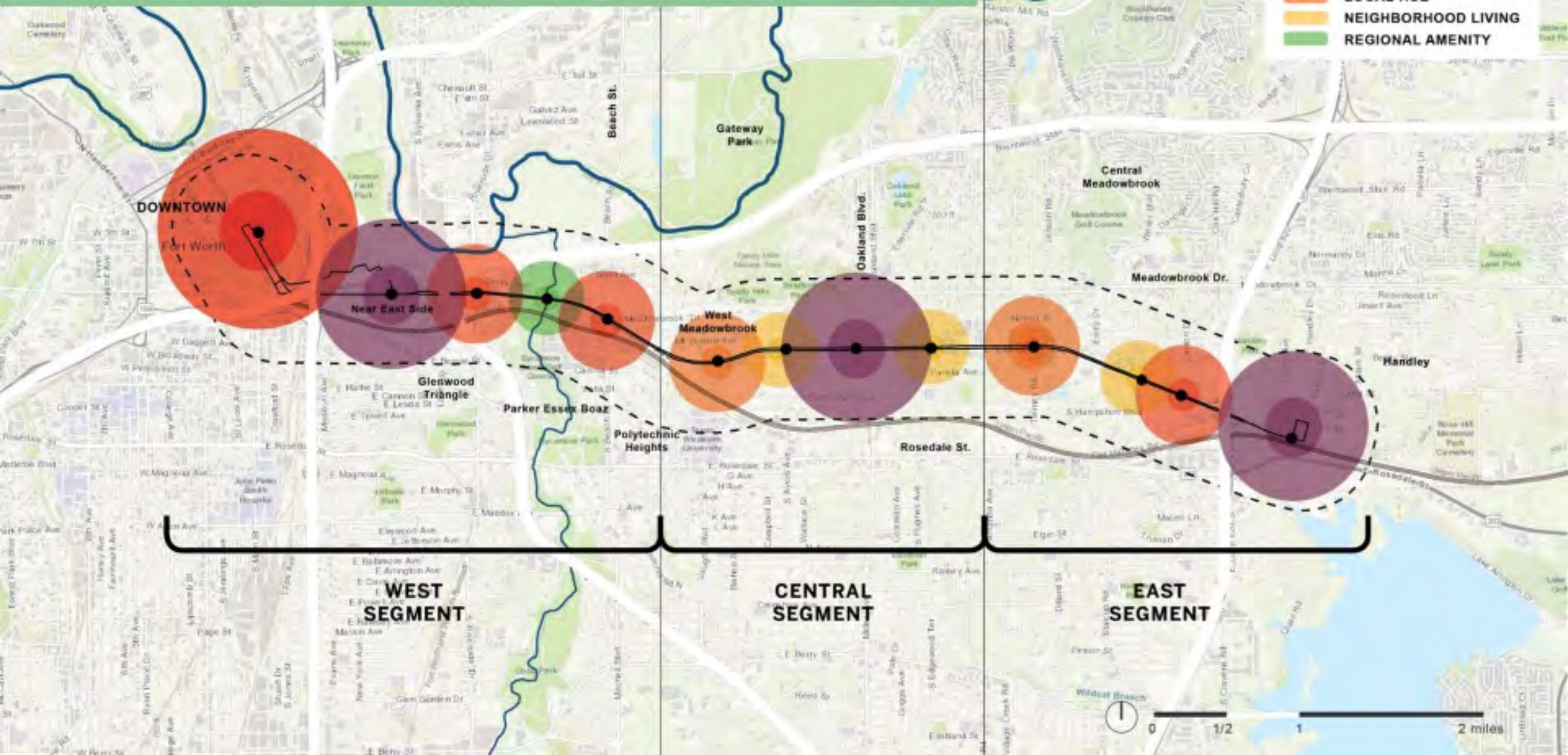

Type 1: The Downtown Core



Role of this Station Area

- Central Business District
- Major Mixed-Use Center
- High-density living

Users

- Regional visitors
- Residents from DFW region
- Transit riders

Connections

- Rail, bus, and bike
- Highways and major streets

Stations Areas to Investigate

Central Station (West Segment)

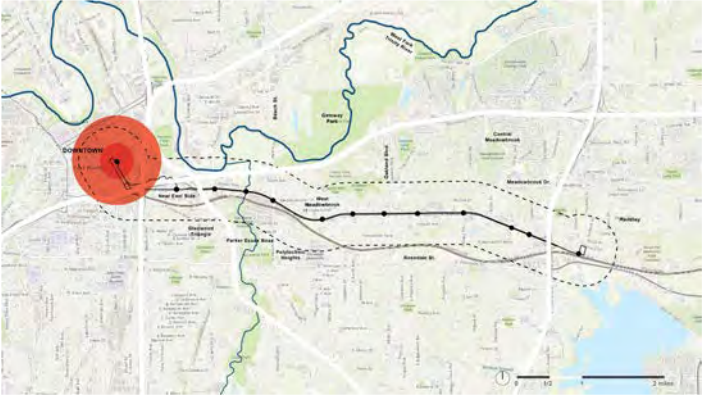

Downtown Core Examples



Type 2: The Urban Village

Station Area Roles

City-wide Destination
Serving Community Needs

Users

Visitors from downtown, East Fort Worth
Residents from neighboring communities
Transit riders and passing traffic

Connections

Bus and bike
Highways and major streets

Stations to Investigate

Near East Side Urban Village/ Pine (West Segment)
Oakland Corners Urban Village/ Sargent (Central Segment)
Handley Urban Village (East Segment)

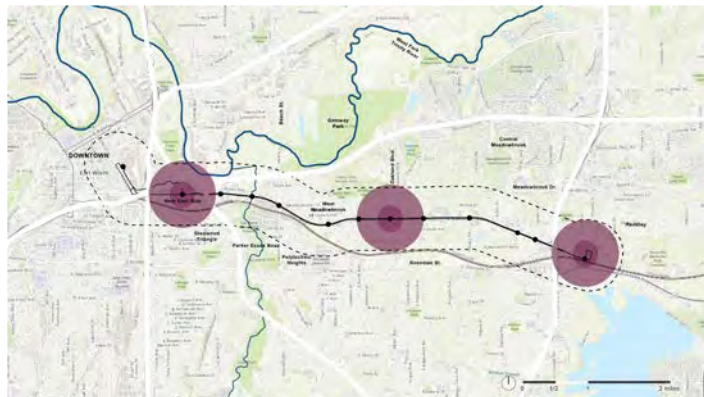

Urban Village Examples



Type 3: The TOD Corridor Hub

Station Area Roles

Corridor Services
Residential

Users:

Visitors from East Fort Worth
East Lancaster residents
Passing traffic, transit riders

Connections:

Bus and bike
Major and local streets

Stations to Investigate

Riverside (West Segment)

Beach/Ward (Central Segment)

Canton (East Segment)

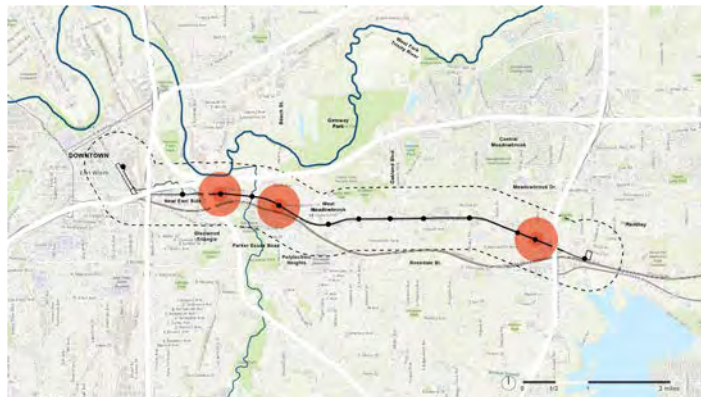

TOD Corridor Hub Examples



Type 4: The TOD Local Hub



Station Area Roles

- Local Services
- Residential

Users

- Local residents
- Passing traffic, transit riders

Connections

- Bike
- Major and local streets

Stations to Investigate

- Collard/Texas Wesleyan (Central Segment)
- Tierney (East Segment)

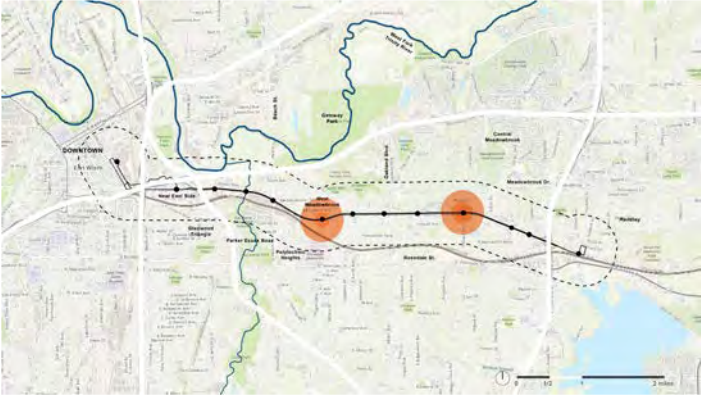

TOD Local Hub Examples



Type 5: Neighborhood Living

Station Area Role

Residential

Users

Local residents

Connections

Bike

Local streets

Stations to Investigate

Ayers (Central Segment)

Rand/Edgewood (Central Segment)

Weiler (East Segment)

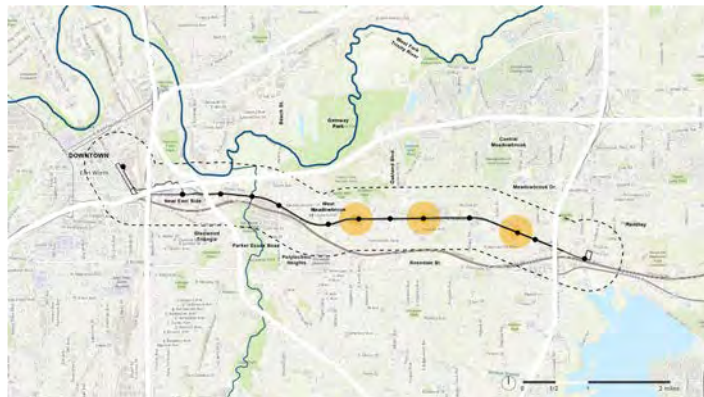

Neighborhood Living Examples



Type 6: Regional Amenity

Station Area Role

- New public open space
- Trail connections

Users

- Regional visitors
- Transit riders

Connections

- Bike
- Local streets

Station:
Bomar/Sycamore Trail (West Segment)



Trinity River Strategic Plan

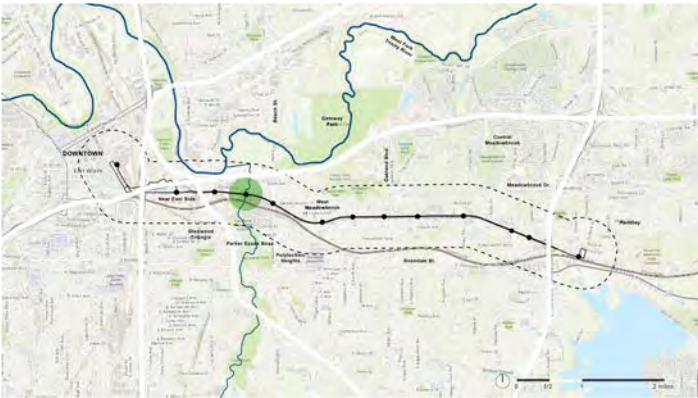

Trinity River Strategic Plan





Type 6: Regional Amenity



Beyond East Lancaster Avenue: Housing Choice for All



Station Area Types and Potential Locations

- DOWNTOWN CORE
- URBAN VILLAGE
- CORRIDOR HUB
- LOCAL HUB
- NEIGHBORHOOD LIVING
- REGIONAL AMENITY

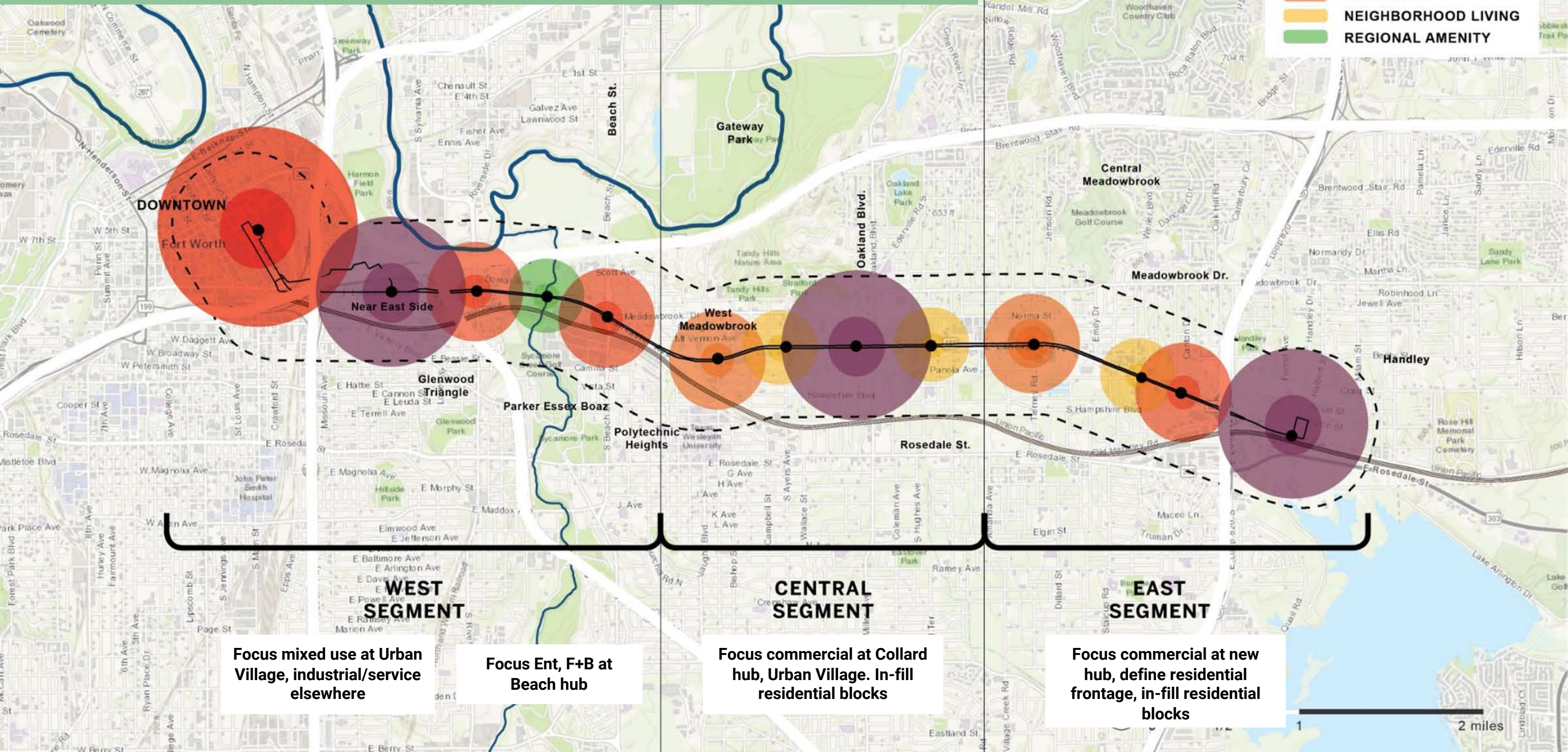

Focus mixed use at Urban Village, industrial/service elsewhere

Focus Ent, F+B at Beach hub

Focus commercial at Collard hub, Urban Village. In-fill residential blocks

Focus commercial at new hub, define residential frontage, in-fill residential blocks

Next Steps

- Launch survey to receive feedback from stakeholders
- Incorporate feedback into station analysis and concept design
- Present concept design and plan recommendations to the public in Fall 2021
- Meetings will be segment specific
- Finalize design and present plan recommendations to Fort Worth City Council in late 2021



Ways to Stay Involved!

- **Subscribe to our email list at advancingeastlancaster.com**
- **Take the survey!**
- **Give your feedback on the interactive map**
- **Follow @TrinityMetro on social media for updates**

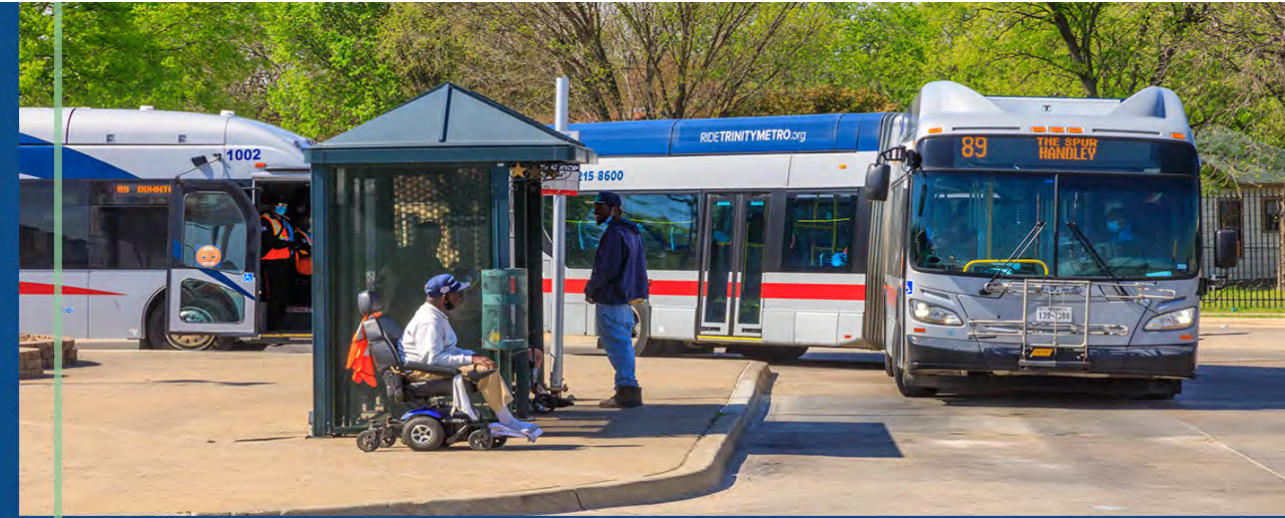

We want to hear what is important to you!
Take the survey.



Questions & Answers



EAST LANCASTER